

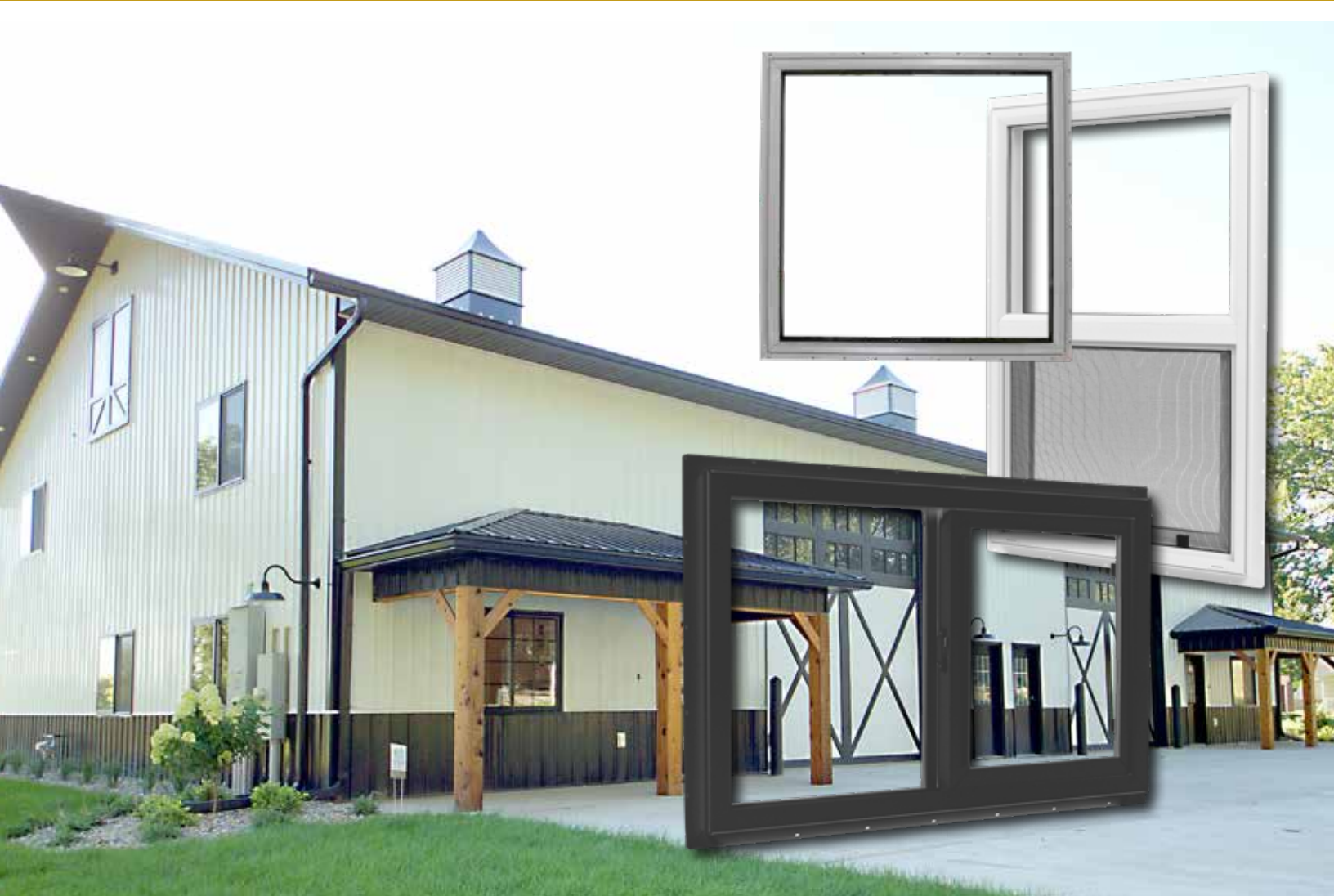

VAE SERIES

HIGH PERFORMANCE VINYL WINDOWS



QUALITY WINDOWS AND CERTIFIED PERFORMANCE FOR ALL STRUCTURES

VINYL VAE SERIES WINDOWS



BUILDING A WORLD OF DIFFERENCE

plyco.com

HIGH PERFORMANCE

VINYL WINDOWS

The PLYCO Victory Vinyl Window combines the simplicity of a side-load design with high performance values. Finally a vinyl window that has look your buildings deserve matched with the ease of install and weathering endurance. The new construction and replacement designs use common sash components.

VICTORY Features

- 1** 3/4 in (19 mm) glazing provide excellent acoustical and energy performance properties to meet current standards
- 2** Interlocking sashes with weather seals guard against air and water infiltration
- 3** Pocket sill configuration provides structural integrity with a product rating up to DP-40, aluminum reinforced
- 4** Multi-chambered frame design features staggered weep system channels for efficient water drainage
- 5** Integral nailfin provides option for use in new-construction and replacement applications
- 6** Frame design options provide choice of (A) standard frame with integral nailing fin, (B) no nailing fin attached, (C) Aluminum Step-Saver or (D) frame with J-Trim (provided by other manufacturer)

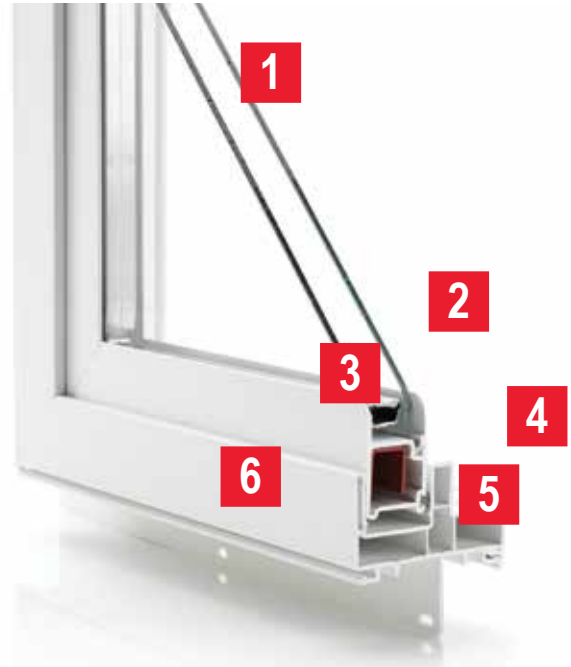

Featuring the Rehau 190 Engineered Frame Material

- Best-in-Class uPVC material (U=Unplasticized)
- Industry Leading Titanium Dioxide at 7 PPH
- Environmentally friendly 12 PPH recycled uPVC scrap material

WINDOW TYPES

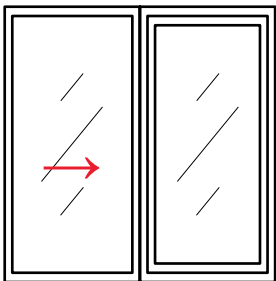

Horizontal Slider

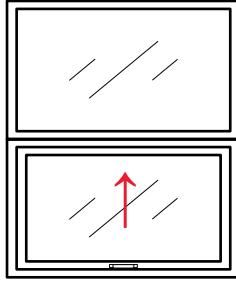

Vertical Single Hung

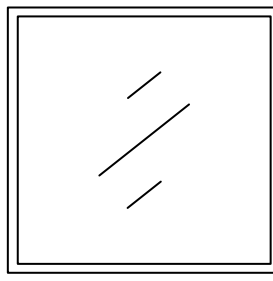

Fixed Window

Available in:



Polar White



Clay

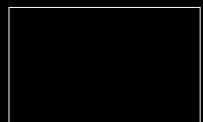

Black

WINDOW INSTALL OPTIONS FOR VARIOUS WALL & SIDING APPLICATIONS

The versatility of Victory allows this window design to be used in a different types of construction for residential, commercial and agricultural applications.



TRIM OPTIONS:

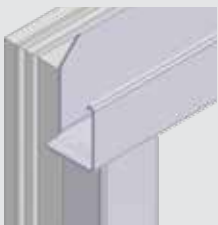

StepSaver Aluminum



Integral Nail Fin

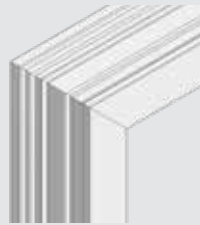

No Fin



J-Trim (provided by others)



**BEST POST-FRAME
APPLICATION -
STEP SAVER**

**Installs after
siding applied**

NAIL FIN APPLICATION



**Argon filled,
warm edge spacer**

LOW-E 272 GLASS - STANDARD

Fixed: Up to 45 psf
Single-Hung/Slider:
Up to 35 psf



Up to STC 34



Air Infiltration
0.20 cfm/ft²



U Value
Down to .28 Btu/hr.ft².°F



VICTORY VINYL WINDOWS

TECHNICAL INFORMATION

Glazing	
Standard	Low-E, Argon Filled, Warm Edge
Grids	Matching color internal grids available
Framing	
Type	Multi-chamber, uPVC
Color Options	White, Clay and Black (foil covering)
Trim Style	Nail fin, Aluminum Step Saver or No Fin
Sashes	
Types	Fixed, single-hung and horizontal slider
Sightlines Frame/Sash	1 3/8 in. to 4 7/8 in. (35 mm to 124 mm)
Weather Stripping	
Sashes	Weather pile with center fin seal
Recommended Applications	
	Residential Light Commercial Heated Facilities, Etc.
Series/Model	
	190 VAE Series

Common Sizes	3/0 x 2/0 3/0 x 3/0 3/0 x 4/0 3/0 x 5/0 4/0 x 2/0 4/0 x 3/0 4/0 x 4/0 SPECIAL SIZES REVIEWED UPON REQUEST
Other Sizes	Available in 1 foot increments from 2/0 x 2/0 to 6/0 x 4/0
Overall Dimensions	Window manufactured to 1/2" less to nominal size. Eg. 4/0 x 3/0 is 47 1/2" x 35 1/2" out to out
Mulling Option	Available
Screens	All operable windows include an aluminum framed, nylon mesh removable insect screen.
FRAMES/ OPERATION	
Depth	2 11/16" (68.6 mm)
Material	Ca/Zn and Lead (Pb) free uPVC
Joints	Welded and cleaned
Sealing System	Weatherpile, flexible co-extrusions
Latch	Face mounted, die-cast zinc, powder coated color to match
Weather-Strip	Weather pile with center fin seal
Standard Glass Thickness	3/4" (19mm)
Standard Glass Type	Low-E 272 (surface 2), argon fill, warm edge spacer
TESTING	
Air Infiltration	<0.20 cfm/ft ²
U-Values	Down to .28 Btu/hr.ft ² .°F (1.4 W/m ² .K)
Structural Tests	Fixed: Up to design pressures of 45 psf Single-Hung: Up to design pressures of 35 psf Single-Slider: Up to design pressures of 35 psf
Sound Reduction	Up to STC 34

*Please contact your sales representative for additional information.

PLYCO[®]
CORPORATION
ELKHART LAKE, WI • 800.558.5895



Because of its ongoing commitment to product improvement, Plyco Corporation reserves the right to change, without notice, product specifications, availability, prices and conditions of sale.

plyco.com